

# KDA Standard Ceramic Screws

## Flat Head Type

We only accept more than 20 pieces per a Model ID.

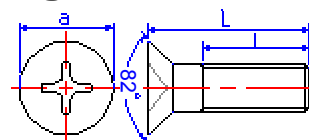

Flat head (inch)				Alumina Al <sub>2</sub> O <sub>3</sub> (JPY)		Zirconia ZrO <sub>2</sub> (JPY)		
Size	a	b	L	l	Model ID	Each price	Model ID	Each price
#1-72	0.146	0.043	3/16	0.142	-	-	UZS1-72-3/16	1,740
#2-56	0.173	0.051	3/19	0.133	UAS2-56-3/16	1,150	UZS2-56-3/16	1,610
			1/4	0.196	UAS2-56-1/4	1,170	UZS2-56-1/4	1,640
			5/16	0.258	UAS2-56-5/16	1,190	UZS2-56-5/16	1,670
			3/8	0.321	UAS2-56-3/8	1,260	UZS2-56-3/8	1,760
#3-48	0.197	0.059	3/1	0.128	UAS3-48-3/16	1,130	UZS3-48-3/16	1,580
			1/4	0.191	UAS3-48-1/4	1,150	UZS3-48-1/4	1,610
			5/16	0.253	UAS3-48-5/16	1,170	UZS3-48-5/16	1,640
			3/8	0.316	UAS3-48-3/8	1,240	UZS3-48-3/8	1,720
#4-40	0.224	0.067	3/16	0.120	UAS4-40-3/16	1,100	UZS4-40-3/16	1,540
			1/4	0.182	UAS4-40-1/4	1,120	UZS4-40-1/4	1,570
			5/16	0.245	UAS4-40-5/16	1,140	UZS4-40-5/16	1,600
			3/8	0.307	UAS4-40-3/8	1,210	UZS4-40-3/8	1,680
#5-40	0.252	0.075	3/16	0.110	UAS5-40-3/16	1,080	UZS5-40-3/16	1,510
			1/4	0.173	UAS5-40-1/4	1,100	UZS5-40-1/4	1,540
			5/16	0.235	UAS5-40-5/16	1,120	UZS5-40-5/16	1,560
			3/8	0.298	UAS5-40-3/8	1,180	UZS5-40-3/8	1,640
			1/2	0.423	UAS5-40-1/2	1,240	UZS5-40-1/2	1,730
#6-32	0.280	0.083	1/4	0.166	UAS6-32-1/4	1,120	UZS6-32-1/4	1,760
			5/16	0.228	UAS6-32-5/16	1,140	UZS6-32-5/16	1,780
			3/8	0.291	UAS6-32-3/8	1,200	UZS6-32-3/8	1,850
			1/2	0.416	UAS6-32-1/2	1,260	UZS6-32-1/2	1,950
#8-32	0.331	0.098	5/16	0.212	UAS8-32-5/16	1,150	UZS8-32-5/16	1,990
			3/8	0.275	UAS8-32-3/8	1,210	UZS8-32-3/8	2,060
			1/2	0.400	UAS8-32-1/2	1,270	UZS8-32-1/2	2,160
			5/8	0.525	UAS8-32-5/8	1,360	UZS8-32-5/8	2,320
			3/4	0.65	UAS8-32-3/4	1,510	UZS8-32-3/4	2,600
#10-24	0.386	0.114	5/16	0.197	UAS10-24-5/16	1,220	UZS10-24-5/16	2,080
			3/8	0.259	UAS10-24-3/8	1,280	UZS10-24-3/8	2,160
			1/2	0.384	UAS10-24-1/2	1,340	UZS10-24-1/2	2,240
			5/8	0.509	UAS10-24-5/8	1,430	UZS10-24-5/8	2,420
			3/4	0.634	UAS10-24-3/4	1,600	UZS10-24-3/4	2,740
			7/8	0.759	UAS10-24-7/8	1,640	UZS10-24-7/8	2,790
			1	0.884	UAS10-24-1	1,680	UZS10-24-1	2,830
#10-32	0.386	0.114	5/16	0.197	UAS10-32-5/16	1,290	UZS10-32-5/16	2,200
			3/8	0.259	UAS10-32-3/8	1,360	UZS10-32-3/8	2,290
			1/2	0.384	UAS10-32-1/2	1,420	UZS10-32-1/2	2,370
			5/8	0.509	UAS10-32-5/8	1,520	UZS10-32-5/8	2,570
			3/4	0.634	UAS10-32-3/4	1,700	UZS10-32-3/4	2,900
			7/8	0.759	UAS10-32-7/8	1,740	UZS10-32-7/8	2,960
			1	0.884	UAS10-32-1	1,780	UZS10-32-1	3,000

\* We often change data above without notice.

\* The size unit above is inch.